



FIDELITY-PHILADELPHIA
TRUST BUILDING

on the east side of

SOUTH BROAD STREET

extending from Sansom to Walnut

PHILADELPHIA

SANSON STREET

WALNUT STREET

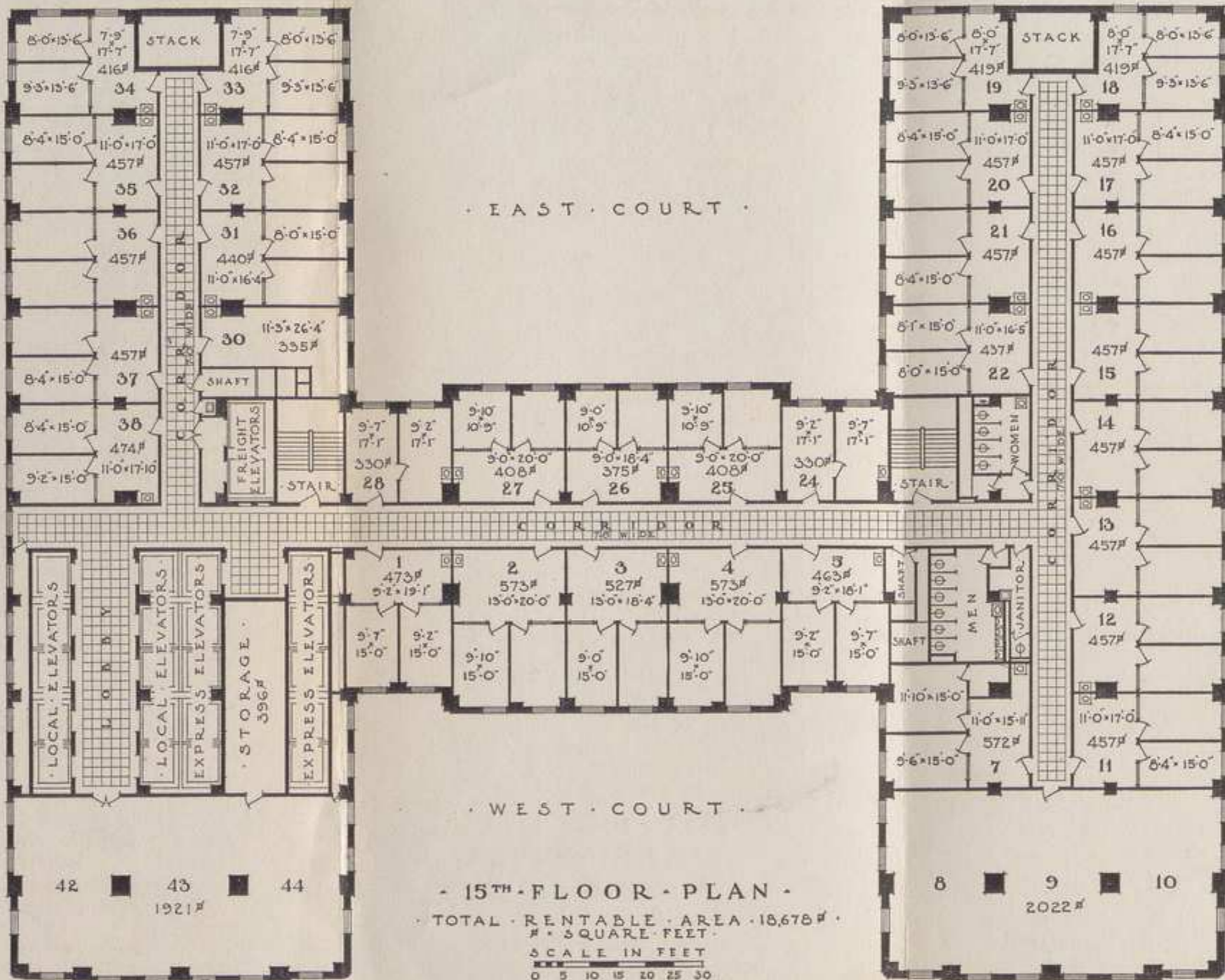

- 15TH FLOOR PLAN -

TOTAL RENTABLE AREA 18,678^{sq} ft.

SCALE IN FEET 0 5 10 15 20 25 30

STATISTICS, *General*

The height of the building is 377 feet from street level.

The cubical content is 11,572,000 cubic feet.

The floor area is 618,249 square feet.

DESIGN OF BUILDING

With a view to providing maximum daylight for all offices, the building has been designed in a form resembling the letter "H," the cross bar, or connecting link of the letter being in the centre of the building, and the north and south ends being built in solid wings.

The light courts, one on Broad Street 50 feet deep and 100 feet wide, and one in the rear of the building 70 feet deep and 100 feet wide, assure maximum supply of daylight.

FINISH, *Exterior*

The exterior of the building is of limestone, above a granite base.

WINDOWS

The window frames and sash throughout the building are of bronze construction.

THE ENTRANCE

The main entrance to the building, at the corner of Broad and Sansom Streets, opens into a large entrance lobby to the elevators.

ELEVATORS, *Public*

Twenty high speed elevators will serve the occupants of the building. Ten of these will run locally to the seventeenth floor; the other ten will render express service to the seventeenth floor, and local above that floor.

There will be two service elevators running from the Company's Safe Deposit Department in the basement to the top floor of the building. These will be available to tenants who may desire to place their securities in the Safe Deposit Department.

VAULTS, *Details*

The bank vaults will be in the centre of the building. The inside clear dimensions are 33 feet 4 inches wide, by 86 feet long. The vault will be built of concrete and steel—entirely independent of other construction, and will be protected by four separate and distinct electric devices.

OCCUPANCY

Up to and including the fifth floor the building covers the lot solidly, i e., the base of the letter "H" is the sixth floor.

Fidelity-Philadelphia Trust Company will occupy a large proportion of the space included in the first five floors. All other space in the building is being leased.

RENTABLE AREA, *Typical Floors*

The net rentable area on each typical floor is from 18,000 to 19,000 square feet.

OFFICE, *Rentable Units*

The office units have been carefully planned to make use of all available daylight. These units vary in depth, a few being 14 feet, but the majority are 26 feet 4 inches, and some are 28 feet in depth. The offices throughout the building with some few exceptions, are 17 feet 4 inches wide. The typical ceiling height is 10 feet 9 inches.

RESERVATIONS

Reservations of space in the building are now being made. The rental agent will be glad to discuss your problems with you and aid you in determining your needs.

FIDELITY-PHILADELPHIA TRUST BUILDING

JOHN B. LEAR

Rental Agent

1202 Liberty Building

Telephone, Rittenhouse 0700